

# OTHER VACUUM PARTS

## Quick Release Handle

Main Frame of Handle  
 Model: YCEH13A  
 Parts No.: T5420

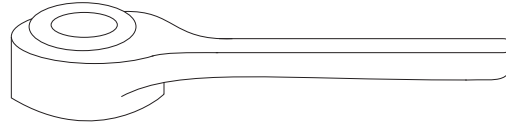

## Hexagon Bolt

Model: YCEH13B8  
 Parts No.: T5421  
 M8 (For RY80,100)

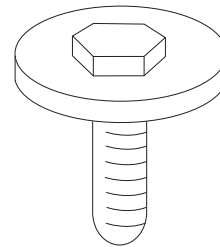

Model: YCEH13B10  
 Parts No.: T5422  
 M10 (For RY120W)

## Adjusting Screw (Round Headed Bolt)

Model: YCES630  
 Parts No.: T5444  
 L= 30 mm (For position)

Model: YCES635  
 Parts No.: T5445  
 L= 35 mm (For RY100)

Model: YCES640  
 Parts No.: T5446  
 L= 35 mm (For RY120)

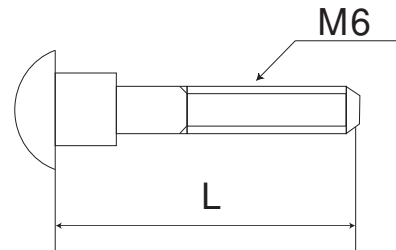

## T Pipe

Model: YCET6  
 Parts No.: T5431

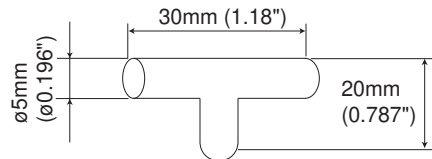

## Air Tube

Model: U2-4-4X6-Y  
 Parts No.: U2-4-4X6-Y  
 1 meter unit

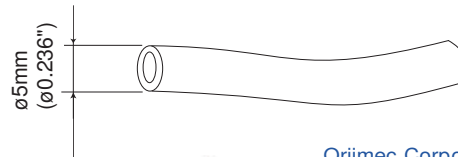

An industry leader in pressroom automation for more than 30 years, Oriimec provides robots, transfer systems, coil handling equipment and straightener/feeder combination units to customers worldwide. Manufactured in Japan, the Orii line of equipment is engineered to meet the specific needs of each of our customers. All Orii products sold in the U.S. are paired with expert service and technical support from our Erlanger, KY office.



Oriimec Corporation of America  
 1840 Airport Exchange Blvd. #200  
 Erlanger, KY 41018  
 U.S.A

Phone:  
 888.746.3320 (toll free)

Tel: 859.746.3318  
 Fax: 859.746.3319  
 Email: [info@oriimec.com](mailto:info@oriimec.com)  
 Website: [www.oriimec.com](http://www.oriimec.com)