

OTHER VACUUM PARTS

Quick Release Handle

Main Frame of Handle
 Model: YCEH13A
 Parts No.: T5420

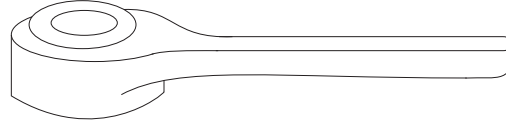

Heagon Bolt

Model: YCEH13B8
 Parts No.: T5421
 M8 (For RY80,100)

Model: YCEH13B10
 Parts No.: T5422
 M10 (For RY120W)

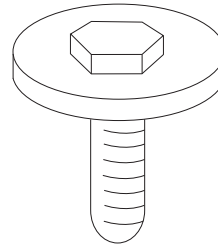

Adjusting Screw (Round Headed Bolt)

Model: YCES630
 Parts No.: T5444
 L= 30 mm (For position)

Model: YCES635
 Parts No.: T5445
 L= 35 mm (For RY100)

Model: YCES640
 Parts No.: T5446
 L= 35 mm (For RY120)

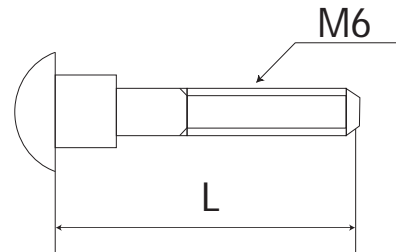

T Pipe

Model: YCET6
 Parts No.: T5431

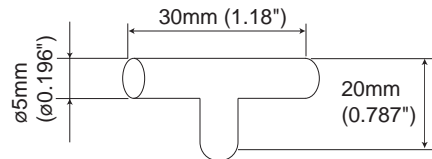

Air Tube

Model: U2-4-4X6-Y
 Parts No.: U2-4-4X6-Y
 1 meter unit

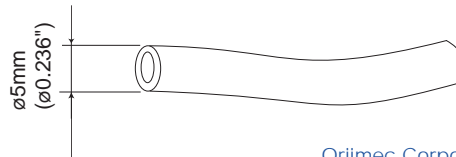

An industry leader in pressroom automation for more than 30 years, Oriimec provides robots, transfer systems, coil handling equipment and straightener/feeder combination units to customers worldwide. Manufactured in Japan, the Orii line of equipment is engineered to meet the specific needs of each of our customers. All Orii products sold in the U.S. are paired with expert service and technical support from our Erlanger, KY office.



Oriimec Corporation of America
 1840 Airport Exchange Blvd. #200
 Erlanger, KY 41018
 U.S.A

Phone:
 888.746.3320 (toll free)

Tel: 859.746.3318
 Fax: 859.746.3319
 Email: info@oriimec.com
 Website: www.oriimec.com